

SWASH 1000



KEY FEATURES

- Instant ceramic heating system for unlimited warm posterior and feminine washes
- Twin adjustable stainless steel nozzles
- Water and seat temperature settings
- Water pressure controls
- Adjustable warm air dryer
- Activated carbon deodorizer to remove odor
- Nozzle oscillation (massage) feature
- Self cleaning nozzles with sterilization
- Aerated wash spray with width adjustment (three levels)
- Intelligent body sensor
- Wireless remote control
- Stylish design and comfortable heated seat
- “Quick Release” for easy seat removal and cleaning
- Gentle closing seat and lid
- 3/8” standard t-valve (for water inlet connection)
- 1/2” standard bidet hose (for seat connection)
- Three (3) year limited warranty

SPECIFICATIONS

Seat Temperature	Adjustable (three levels) 31.1°C – 37.2°C
Water Temperature	Adjustable (three levels) 31.7°C – 37.5°C
Air Dryer Temperature	Adjustable (four levels) Off, 31°C – 37°C
Power Cord Length	106.7 cm
Plug Type	Type F CEE 7/7
Max Power Consumption	1,200W
Voltage / Frequency	220V / 50Hz
Elongated Model #	S1000-EW220V (white)
Dimensions	38.1cm (W) x 52.8cm (L) x 14.5cm (H)
Weight	6.5 kg
Round Model #	S1000-RW220V (white)
Dimensions	38.1cm (W) x 49.2cm (L) x 14.5cm (H)
Weight	6.0 kg

FIT GUIDELINES

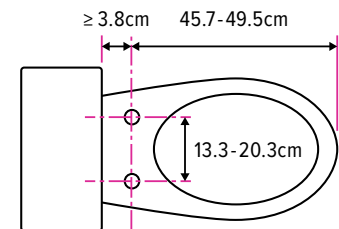

ELONGATED

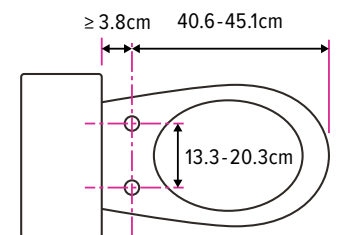

ROUND

